

# ALTA WEST GRAY

Client: Wood Partners

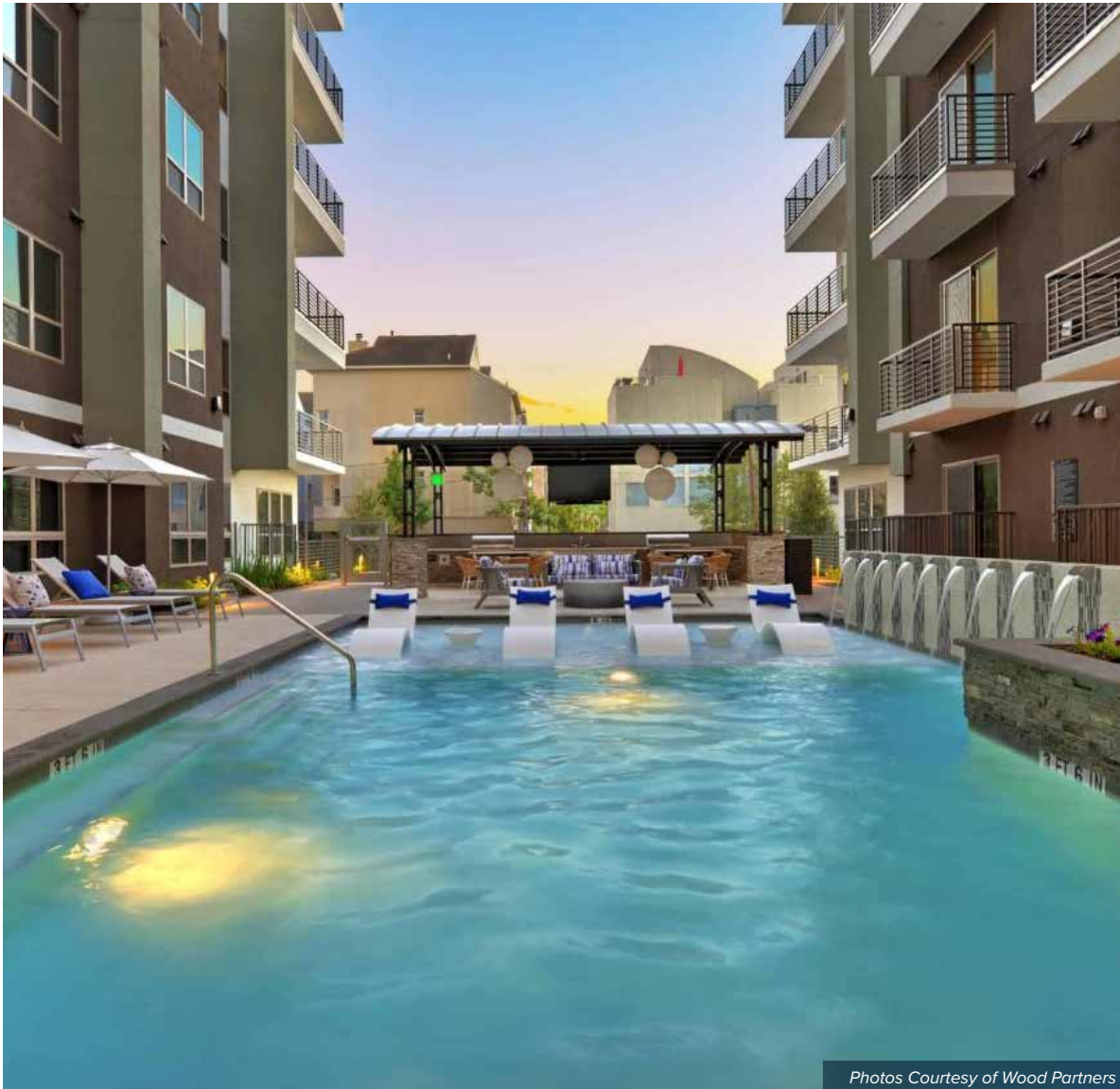

Photos Courtesy of Wood Partners

<b>MF</b> Multi-family	<b>G</b> Parking Garage
<b>TX</b> Houston	<b>6</b> Stories
<b>5</b> Stories Type 3A Wood Frame Construction	<b>1</b> Story Type 1A at Grade Parking Structure
<b>2</b> Story Basement Parking Structure	<b>166</b> Units
<b>1.05</b> Acres	<b>159</b> DU/AC
<b>720 - 1,310</b> SF per Unit	<b>191</b> Parking Spaces
<b>Complete</b> 2019	<b>A</b> Architecture